

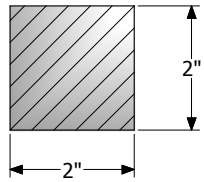

1325 Furneaux Road, Plumas Lakes, CA. 95961
 (530) 742-9675
 www.placerwaterworks.com

RECYCLED WATER VALVE STEM EXTENSION



SECTION A-A

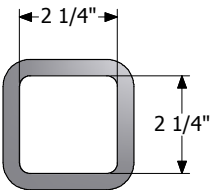

SECTION C-C

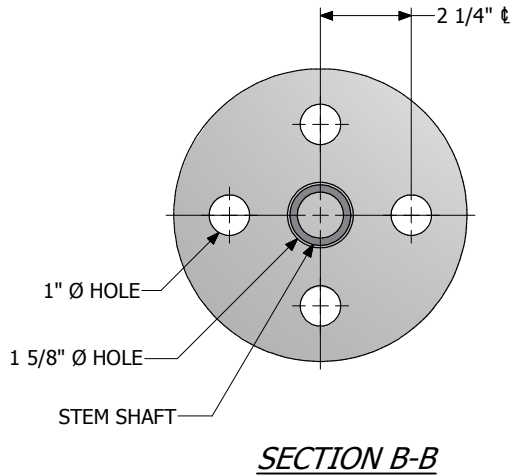

SECTION B-B

NOTES:

1. VALVE STEM EXTENSION LENGHT VARY.
2. VALVE STEM EXTENSION TO HAVE ONE 7" Ø x 1/4" CENTERING RINGS (FREE FLOAT).
3. VALVE STEM EXTENSION MATERIALS TO BE 1-1/2" x .180" ROUND BAR.
4. VALVE STEM EXTENSION TO HAVE 2" SQ. SOLID OPERATOR NUT AND 2 1/4" SQ. SOCKET.
5. ALL PARTS TO BE HOT DIP GALVANIZED AFTER FABRICATION.
6. ALL WELDING ARE DONE PER AWS SPECIFICATIONS.

CAT#: PW/ VE- CSTM

COPYRIGHTED 2016 PLACER WATERWORK, INC. © ALL RIGHTS RESERVED - FOR DUPLICATION AUTHORIZATION MAY OBTAIN THRU: kkern@placerwaterworks.com

*** **CB: R.V.** 03-03-2016 REV.00

